

PRODUCT  
CATALOGUE  
2022

PANIDIS   
MAKEDONIKI • ALUMINIUM SYSTEM COMPONENTS

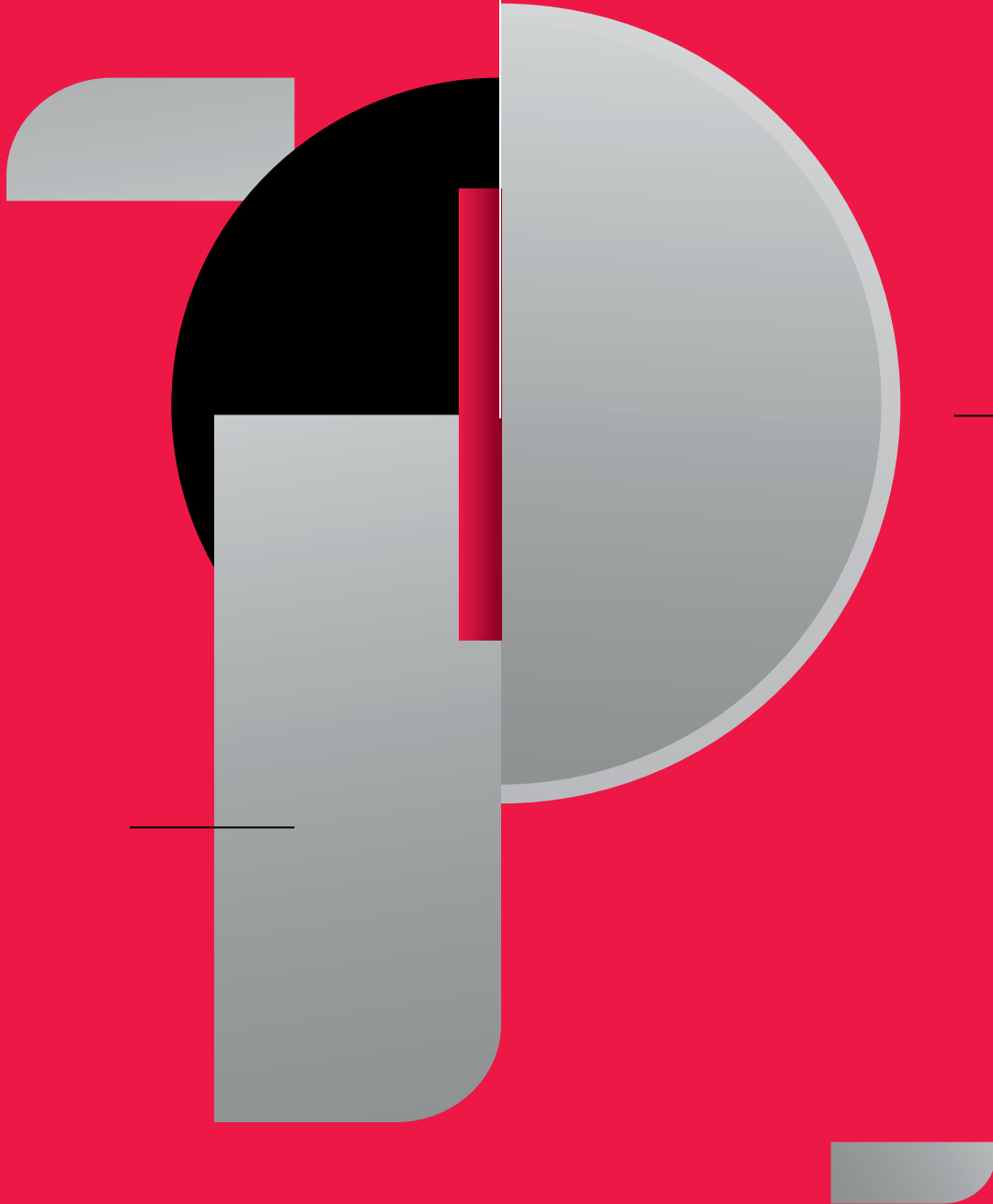



# INDEX

	PAGE
COMPANY PROFILE	03
GLASS DOORS SYSTEMS & ACCESSORIES	05
SHOWERING SYSTEMS & ACCESSORIES	21
RAILINGS & BALLUSTRADES	29
PIVOT MECHANISMS	41
CONCEALED HINGES	47
PIVOTING HANDLES	52
PULL HANDLES	63
ALUMINIUM ACCESSORIES	71







## COMPANY PROFILE

---

Panidis SA was founded in 1974 by Mr. Grigoris Panidis with the distinctive name "Macedonian brass". The company's initial engagement was the processing and engraving of brass products, but soon it focused on the design and production of aluminium parts. Over the years and with the entry of the second generation in the company's administration, from a family company with limited human resources, it has become one of the leading companies in the Greek market, with hundreds of customers and exports to 25 countries in 3 continents. Until today, continuous investment in know-how and engineering equipment coupled with high-skilled personnel, suitably trained and with years of experience in manufacturing, have established Panidis SA as one of the most modern and dynamically developing Greek producers in the aluminium parts industry.

---

The high quality of all the products and services it provides, the highly competitive prices and the continuous research for the design and production of new innovative products, ensure a greate future development for Panidis SA, in the domestic but also international market for aluminium parts.

The vertical production installations, equipped with state-of-the-art CNC machining centers and lathes and with modern anodizing and powder coating units, produces 100% Greek products, with a wide range of accessories for aluminium systems, glazing accessories and aluminium railings. All products are constantly on stock and can be promptly delivered throughout Greece and abroad.





# PANIDIS

MAKEDONIKI • ALUMINIUM SYSTEM COMPONENTS



- 1974** Establishment of the company by Grigorios Panidis. The company's initial engagement was the processing and engraving of brass products PANIDIS SA is founded by Mr. G. Panidis
- 1985** Market Introduction of Aluminum Railings System (MAK SYSTEM by PANIDIS SA)
- 1993** Focus on the design and production of molded aluminium components for door and window frames
  - Establishment of Athens Premises (Warehouse & Show Room)
- 1995** Upgrade production capacity of Architectural Aluminum components
- 2000** Creation of new facilities of 3500m<sup>2</sup>
  - Expansion of Headquarters premises with additional 3.500 m<sup>2</sup>
- 2002** Establishment of powder coating line for aluminium components
  - Installation of Powder Coating Plant
- 2006** Investment in CNC machining centers for the production of innovative and qualitative products
  - Investment in CNC Machining Centers
- 2007** Provision of bespoke solutions in extrusion for leading aluminium manufacturers by designing and producing specialized components
  - Enlarge Market penetration by developing Custom Made Solutions
- 2009** Establishment of a state-of-the-art anodizing line
  - Installation of new state-of-the-art Anodization Plant
- 2014** New market entry. Design and production of aluminium components and aluminium systems for glass
  - Launching of new Glass Accessories Product Portfolio
- 2018** Investment in 10 new CNC machining centers for the improvement of productivity
  - Expand production capacity / additional investment in new CNC Machining Centers



# SHOWERING SYSTEMS & ACCESSORIES

## CONTENTS

## PAGES

●	<b>SHOWERING SYSTEMS</b>	<b>22 - 28</b>
○	<b>GS-R10</b>	STRAIGHT LINE CABIN, WITH ONE SLIDING DOOR & ONE FIXED
○	<b>GS-R11</b>	CORNER CABIN, WITH ONE SLIDING DOOR & TWO FIXED
○	<b>GS-R12</b>	CORNER CABIN, WITH TWO SLIDING DOORS & TWO FIXED
○	<b>GS-R13</b>	CORNER CABIN, WITH TWO SLIDING DOORS & THREE FIXED
●	<b>HANDLES</b>	
○	<b>GK-10</b>	DOOR KNOBS
○	<b>GS-R15</b>	FLUSS PULL HANDLE
○	<b>GHT-500</b>	TOWEL BAR
●	<b>SHOWERING SYSTEMS ACCESSORIES</b>	

### AVAILABLE SHDES



Natural  
anodizing

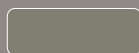

Inox look  
anodizing

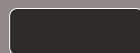

Black  
anodizing



Download the brochure

### **GS-R10**

STRAIGHT LINE INSTALLATION CABIN,  
WITH ONE SLIDING DOOR AND ONE FIXED GLASS PANEL

Aluminium sliding door shower cabin with a minimalistic profile for an aesthetic design.

- Glass thickness range from **8mm** to **10mm**.
- Indicative cabin dimensions: **2000x2000mm**.
- The system consists of **3** aluminum profiles of length **6,1m** each.
- Flush pull handle for ease of use.
- Floor guide that does not need to be drilled onto the bottom of the shower.
- Adjustable rollers (**±2.5mm** per roller) to adjust the sliding glass panel alignment.
- Transparent silicone sealants for absolute waterproofing.
- Wheelchair user-friendly.
- Complete installation handbook provided.





### **GS-R11**

#### **CORNER INSTALLATION CABIN, WITH ONE SLIDING DOOR AND TWO FIXED GLASS PANELS**

Aluminium sliding door shower cabin with a minimalistic profile for an aesthetic design.

- Glass thickness range from **8mm** to **10mm**.
- Indicative shower cabin dimensions: **2000mm** length, **1000mm** width, **2000mm** height.
- The system consists of **3** aluminum profiles of length **6,1m** each.
- Flush pull handle for ease of use.
- Floor guide that does not need to be drilled onto the bottom of the shower.
- Special component for connecting the rail driver with the corner end rail.
- Adjustable rollers (**±2.5mm** per roller) to adjust sliding glass panel inclination.
- Transparent silicone sealants for absolute waterproofing.
- Wheelchair user-friendly.







### **GS-R12**

#### **CORNER INSTALLATION CABIN, WITH TWO SLIDING DOORS AND TWO FIXED GLASS PANELS**

Aluminium sliding door shower cabin with a minimalistic profile for an aesthetic design.

- Glass thickness range from **8mm** to **10mm**.
- Indicative shower cabin dimensions: **1000mm** length, **1000mm** width, **2000mm** height.
- The system consists of **3** aluminum profiles of length **6,1m** each.
- Flush pull handle for ease of use.
- Floor guide that does not need to be drilled onto the bottom of the shower.
- **90°** special angle fittings for the rail driver and base, for better fit.
- Transparent silicone sealants for absolute waterproofing.
- Adjustable rollers (**±2.5mm** per roller) to adjust the sliding glass panel inclination.
- Wheelchair user-friendly.





### GS-R13

#### THREE SIDED INSTALLATION CABIN, WITH TWO SLIDING DOORS AND THREE FIXED GLASS PANELS

Aluminium sliding door shower cabin with a minimalistic profile for an aesthetic design.

- Glass thickness range from **8mm** to **10mm**.
- Indicative shower cabin dimensions:  
**1000mm** length, **1000mm** length of fixed glass, **1000mm** width, **2000mm** height.
- The system consists of **3** aluminum profiles of length **6,1m** each.
- Flush pull handle for ease of use.
- Floor guide that does not need to be drilled onto the bottom of the shower.
- **90°** special angle fittings for the driver and base, for better fit .
- Transparent silicone sealants for absolute waterproofing.
- Adjustable rollers (**±2.5mm** per roller) to adjust the sliding glass panel inclination.





### GK-10

#### PAIR OF GLASS DOOR KNOBS

For shower cabins and glass doors.

- Suitable for glass thickness of **8mm-10mm** and **12mm**.
- Diameter **Ø30**, length **40mm**.
- CNC machined aluminium.

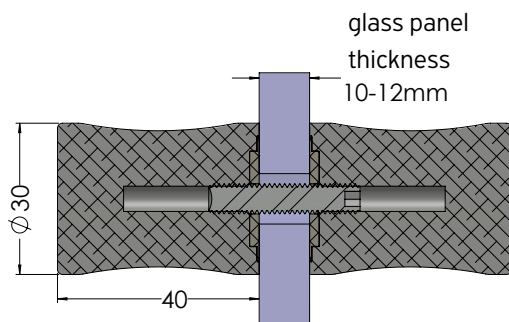
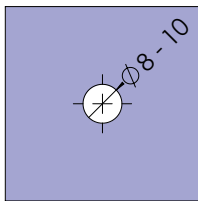

### GS-R15

#### FLUSH PULL HANDLE

For sliding shower cabins and sliding glass doors.

- Suitable for glass thickness of **8mm** and **10mm**.
- Diameter **Ø55**, length **7mm**.
- CNC machined aluminium.

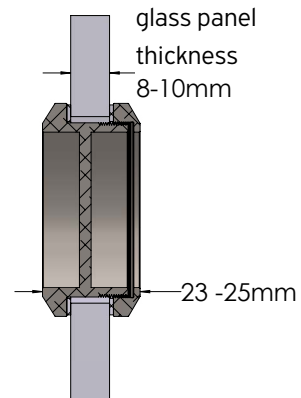
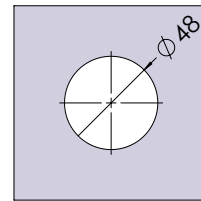



### GHT-500

#### ALUMINIUM TOWEL BAR FOR GLASS DOORS OR FIXED SHOWER GLASS PANELS

For glass shower doors or fixed glass panels.

- Suitable for **8mm-10mm** and **12mm** glass thickness.
- Section **15x15mm**, length **495mm**.
- CNC machined aluminium.

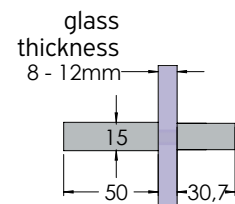
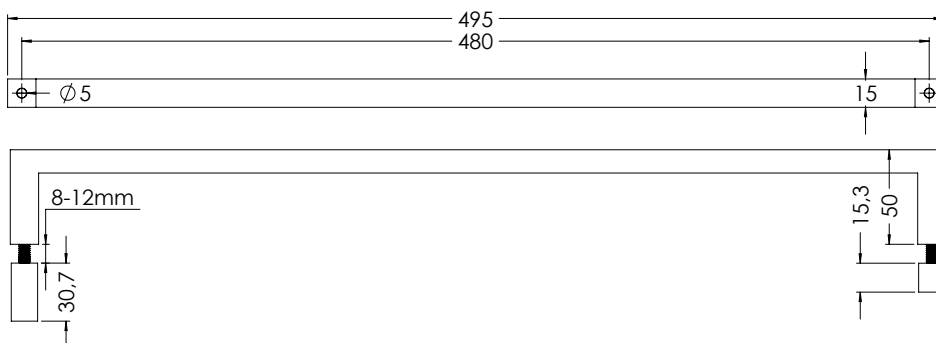
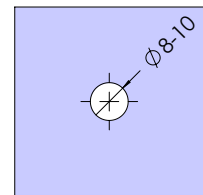



### PROFILES FOR SHOWERING SYSTEMS



GS-R10-101  
main profile

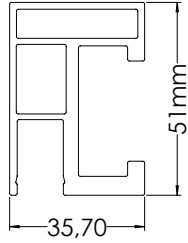

GS-R10-106  
U-shape

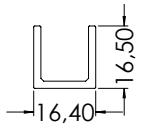

GS-R10-105  
cover

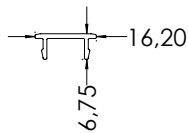

### GS-R10-KIT



GS-R10-104  
stopper



GS-R10-400  
floor guide



GS-R10-110  
wall mount



GS-R10-200  
adjustable roller

### CONNECTION ANGLES FOR SHOWERING SYSTEMS



GS-R10-109  
corner nexus



GS-R10-107 L or R  
nexus for stable panel

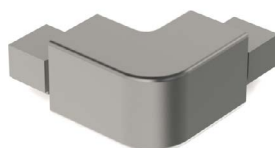

GS-R10-113  
floor corner nexus



GS-R15  
fluss pull handle

## Find us on social media



**ΠΑΝΙΔΗΣ ΑΒΕΕ**

για να κατεβάσετε τον  
κατάλογο προϊόντων  
κάντε click ή scan



**PANIDIS-SA**

click or scan to  
download  
the product catalogue

## PANIDIS SA

### Headquarters & Factory

11th km Old National Road  
Thessaloniki - Kilkis  
P.O. Box 141 • P.C. 570 08  
Ionia • Thessaloniki • Greece

**T** +30 2310 0 780 352

+30 2310 784 519

**F** +30 2310 783 764

### Athens Branch

38 Chr. Lada & Lisia  
P.C. 121 32  
Peristeri • Athens • Greece

**T** +30 210 5155 430

+30 210 5155 439

**F** +30 210 5155 434